



***XHD Lithium  
Cordless Planer  
Brushless 18V -  
Bare Tool***

---

**TSC32**

---



**OPERATORS MANUAL**



## TABLE OF CONTENTS

<b>Specifications</b> .....	<b>3</b>
<b>Product Identification</b> .....	<b>4</b>
<b>Safety Guidelines</b> .....	<b>5</b>
<b>Assembly</b> .....	<b>9</b>
<b>Operation</b> .....	<b>15</b>
<b>Maintenance</b> .....	<b>17</b>

**DISTRIBUTED BY:**



### **Note**

This manual is for your reference only. Due to the continuous improvement of the XHD Lithium products, changes may be made at any time without obligation or notice.

### **Thank You**

For the purchase of this XHD Lithium product. We try our hardest to supply customers like you with the best quality products available, at the best price possible. We cant wait to continue working together in the future.



## SPECIFICATIONS

<i>Planing Width</i>	80mm (3-1/5")
<i>Planing Depth</i>	0-2mm
<i>Rabbeting Depth</i>	17mm
<i>No Load Speed</i>	14,000 RPM
<i>Overall Length</i>	300mm
<i>Net Weight</i>	3.4 kg
<i>Rated Voltage</i>	18 VDC

## PRODUCT IDENTIFICATION



- 1 Depth Adjustment Knob
- 2 Dust Extraction Port
- 3 Lock-Off Lever
- 4 Switch Trigger
- 5 Ergonomic D-Handle
- 6 Attachment Holes
- 7 XHD Battery (Not Included)

## SAFETY GUIDELINES

**WARNING**

*READ ALL SAFETY WARNINGS & INSTRUCTIONS. Failure to follow instructions and warnings could lead to serious injury, electric shock, or fire.*

### Work Area Safety

- **Ensure that your work area is kept clean and well lit.** Lack of visibility and clutter greatly increase the risk of accident when using tools.
- **Keep bystanders, pets, and children clear when operating this power tool or machine.** They can cause distraction or risk injury to themselves.
- **Ensure you are not operating the power tool or machinery in the presence of dust, liquids, flammable gases, or anything that can create an explosive atmosphere.** Power tools and machinery can create sparks which can lead to ignition and fire hazards in working environments.

### Personal Safety

- **Always wear personal protective equipment (PPE).** Eye protection, ear protection, dust masks, and other protective equipment will help to reduce the risk of personal injury or long-term illnesses.
- **Dress appropriately. DO NOT wear loose clothing that can get caught in moving parts.** Keep hair, loose clothing, jewellery, and anything else that could be of risk, away

from moving parts in the machine, or they could become caught therein.

- **Always remain alert and DO NOT operate power tools or machinery under the influence of any substances such as alcohol or drugs, including prescription medications.** Lack of focus could lead to injury or accidents while operating these power tools and machinery.
- **Always ensure proper footing and balance.** Overreaching can lead to slipping and falling which can result in injury or accident.
- **Ensure the power switch is in the OFF position before connecting any battery, or power source to the power tool or machinery.** This can cause injury as tools and machinery can suddenly fire incidentally when live, causing accidents.
- **Use all provided dust collection and extraction attachments, if included.** This equipment, along with the use of PPE dust masks, can help keep you safe from dust inhalation, and keep your work site clear from hazards.
- **Ensure loose parts such as wrenches or adjusting keys are removed before starting the power tool or machinery.**



## SAFETY GUIDELINES

### Power Tool & Machinery Use & Care

- **Use the correct tool for the job.** Forcing a tool to do a job it was not designed for increases the risk of accident or injury.
- **Disconnect tools and machinery from power, or remove batteries before doing any maintenance or adjustments, or before storing the tools and machinery.** This reduces or removes the risk of a power connection that causes the tool or machinery to accidentally fire, which can help prevent injury or accident.
- **Check the general condition of the power tool for damage or any problems that could affect the way the tool or machine works.** An unrepaired tool or machine can lead to accident and injury. Only have your tool or machine repaired with genuine parts from your local distributor
- **Only use the power tool and machinery with genuine parts or accessories that are designed to be used with this power tool and machinery.** Failure to do so could result in accident or injury, or damage your tool or machinery.
- **Store your tool or machinery out of reach of children, and away from untrained personnel when not in use.** Use by somebody untrained, or a child, could lead to accident or serious injury.

### Service

- **Have your tools and machinery serviced by your local distributor with genuine XHD Lithium replacement parts.** This will ensure that the safety of the power tool or machine is maintained.



### WARNING

*The warnings and precautions discussed in this manual cannot cover all possible conditions and situations that may occur. It must be understood by the operator that common sense and caution are factors which cannot be built into this product, but must be supplied by the operator.*

### Always Use Common Sense

- It is not possible to cover every conceivable situation you can face. Always exercise care and use your common sense. If you get into a situation where you feel unsafe, stop and seek expert advice. Contact your dealer, service agent, or an experienced user. Do not attempt any task you feel unsure of!
- **Do not let familiarity gained from the frequent use of tools allow you to become complacent and ignore tool safety principles.** A careless action can cause severe injury within a fraction of a second.



## SAFETY GUIDELINES

### Battery Tool Use & Care

- Prevent unintentional starting. Ensure the switch is in the OFF position before connecting to the battery pack, picking up, or carrying the machine. Carrying the machine with your finger on the switch or energising a machine that has the switch ON invites accidents.
- Disconnect the battery pack from the machine before making any adjustments, changing accessories, or storing the machine. Such preventive safety measures reduce the risk of starting the machine accidentally.
- Recharge the battery only with the charger specified by the manufacturer. A charger that is suitable for one type of battery pack may create a risk of fire when used with another battery pack.
- Use machines only with specifically designated battery packs. Use of any other battery packs may create a risk of injury and fire.
- When the battery pack is not in use, keep it away from other metal objects, like paper clips, coins, keys, nails, screws, or small metal objects, that can make a connection from one terminal to another. Shorting the battery terminals together may cause burns or a fire.
- Under abusive conditions, liquid may be ejected from the battery; avoid contact. If contact accidentally occurs, flush the area with water. If liquid contacts eyes, seek medical help. Liquid ejected from the battery may be acidic and may cause irritation or burns.
- Do not use a battery pack or machine that is damaged or modified. Damaged or modi-

fied batteries may exhibit unpredictable behaviour resulting in fire, explosion, or risk of injury.

- Do not expose a battery pack or machine to fire or excessive temperature. Exposure to fire or temperature above 130°C may cause explosion.
- Follow all charging instructions and do not charge the battery pack or machine outside of the temperature range specified in the instructions.
- Charging the battery improperly, or at temperatures outside of the specified range may damage the battery and increase the risk of fire.
- Have servicing performed by a local XHD distributor repair person using only identical replacement parts. This will ensure that the safety of the product is maintained.
- Do not modify or attempt to repair the machine or the battery pack except as indicated in the instructions for use and care.

### Battery Long Life Tips

- Charge the battery cartridge before it is completely discharged. Always stop tool operation and charge the battery cartridge when you notice less tool power.
- Never recharge a fully charged battery cartridge. Overcharging shortens the battery service life.
- Charge the battery cartridge with room temperature at 10°C – 40°C. Allow a hot battery cartridge to cool before charging it.
- Charge the battery cartridge once in every six months if you do not use it for extended periods at a time.

## SAFETY GUIDELINES

### Cordless Planer Specific Safety

- Wait for the cutter to stop before setting the tool down. An exposed rotating cutter may engage the surface leading to possible loss of control and serious injury.
- Use clamps or another practical way to secure and support the workpiece to a stable platform. Holding the work by your hand or against the body leaves it unstable and may lead to loss of control.
- Rags, cloth, cord, string, and the like should never be left around the work area.
- Avoid cutting nails. Inspect for and remove all nails from the workpiece prior to operation.
- Use only sharp blades. Handle the blades very carefully.
- Be sure the blade installation bolts are securely tightened before operation.
- Hold the tool firmly with both hands.
- Keep hands/fingers away from rotating parts.
- Before using the tool on an actual workpiece, let it run for a while. Watch for abnormal vibrations or wobbling that could indicate poor installation or a poorly balanced blade.
- Make sure the blade is not contacting the workpiece before the switch is turned on.
- Wait until the blade attains full speed before cutting.
- Always switch off and wait for the blades to come to a complete stop before any adjusting.
- Never stick your finger into the chip chute. The chute may jam when cutting damp wood. Clean out chips with a stick.
- Do not leave the tool running. Operate the tool only when hand-held.

- Always change both blades or covers on the drum simultaneously, otherwise the resulting imbalance will cause vibration and shorten the tools life.
- Always use the correct dust mask/respirator for the material and application you are working with.

### WARNING

*Some dust created by power sanding, sawing, drilling, planing, and other construction activities contains chemicals known to cause cancer, birth defects or other reproductive harm. Some examples of these chemicals are:*

- *Lead from lead-based paint,*
- *Crystalline silica from bricks and cement and other masonry products, and,*
- *Arsenic and chromium from chemically-treated lumber.*

*Your risk from these exposures varies, depending on how often you do this type of work. To reduce your exposure to these chemicals: work in a well ventilated area, and work with approved safety equipment, such as dust masks that are specially designed to filter out microscopic particles.*

## ASSEMBLY

### WARNING

*Always be sure that the tool is switched off and the battery cartridge is removed before adjusting or checking the tool.*

### Installing or Removing the Battery

- To remove the battery cartridge, slide it from the tool while depressing the button on the front of the cartridge.
- To install the battery cartridge, align the tongue on the battery cartridge with the groove in the housing and slip it into place. Insert it all the way until it locks in place with a little click. If you can see the red indicator on the upper side of the button, it is not locked completely.

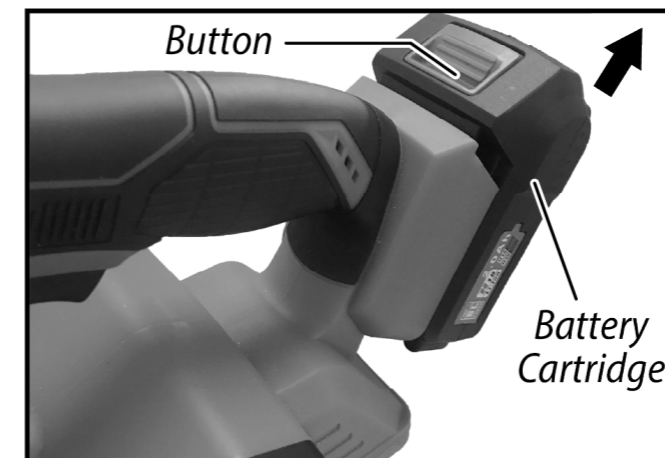

### CAUTION

*Do not install the battery cartridge forcibly. If the cartridge does not slide in easily, it is not being inserted correctly.*

### Battery Protection System

- The tool will automatically stop during operation if the tool and/or battery are placed under one of the following conditions:

#### Overloaded:

- The tool is operated in a manner that causes it to draw an abnormally high current.
- In this situation, release the switch trigger on the tool and stop the application that caused the tool to become overloaded. Then pull the switch trigger again to restart.
- If the tool does not start, the battery is overheated. In this situation, let the battery cool before pulling the switch trigger again.

#### Low Battery Voltage:

- The remaining battery capacity is too low and the tool will not operate. In this situation, remove and recharge the battery.

### Adjusting Depth of Cut

- The depth of cut may be adjusted by simply turning the knob on the front of the tool so that the arrow pointer points to the desired depth of cut.

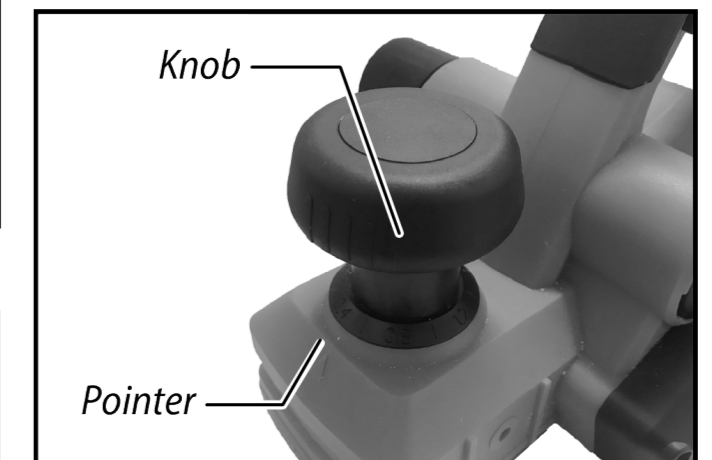

## ASSEMBLY

### Switch Action

#### CAUTION

Before installing the battery cartridge into the tool, always check to see that the switch trigger actuates properly and returns to the "OFF" position when released.

Do not pull the switch trigger hard without pressing the lock-off lever. This can cause switch breakage.

- To prevent the switch trigger from being accidentally pulled, a lock-off lever is provided. To start the tool, slide the lock-off lever and pull the switch trigger. Release the switch trigger to stop.

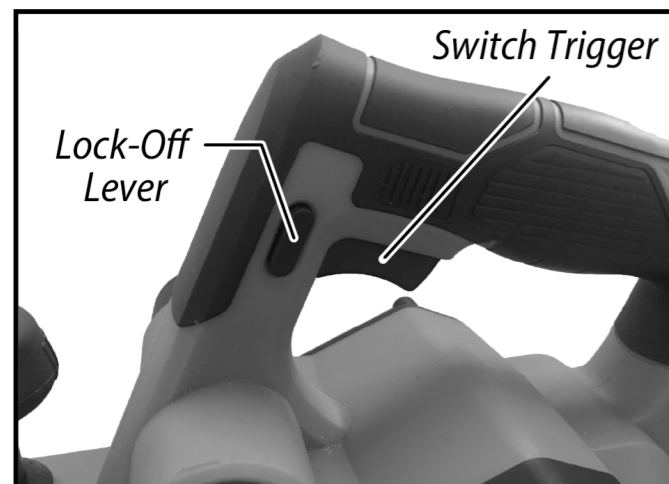

- To prevent the switch trigger from being accidentally pulled, a lock-off button is provided.
- To start the tool, depress the lock-off button and pull the switch trigger. Release the switch trigger to stop.

#### WARNING

For your safety, this tool is equipped with a lock-off lever which prevents the tool from unintentionally starting. NEVER use the tool if it runs when you simply pull the switch trigger without pressing the lock-off lever. Return the tool to your nearest XHD distributor for proper repairs BEFORE further usage.

NEVER tape down or defeat the purpose and function of the lock-off lever.

### Foot

- After completing a cutting operation, lift the back of the tool until a foot protrudes under the level of the rear base. This prevents the tool blades from being damaged.

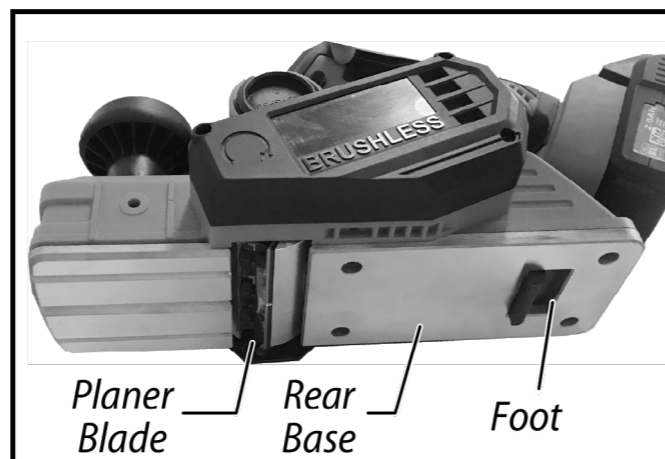

## ASSEMBLY

### Installing or Removing Mini Planer Blades

#### CAUTION

Tighten the blade installation bolts carefully when attaching the blades to the tool. A loose installation bolt can be dangerous. Always check to see they are tightened securely.

Handle the blades very carefully. Use gloves or rags to protect your fingers or hands when removing or installing the blades.

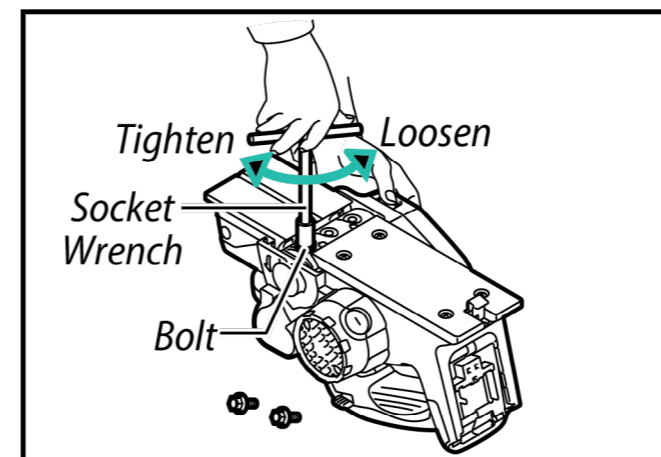

- Remove the existing blade, if the tool has been in use, carefully clean the drum surfaces and the drum cover. To remove the blades on the drum, unscrew the three installation bolts with the socket wrench. The drum cover comes off together with the blades.
- To install the blades, loosely attach the adjusting plate to the set plate with the pan head screws and set the mini planer blade on the gauge base so that the cutting edge

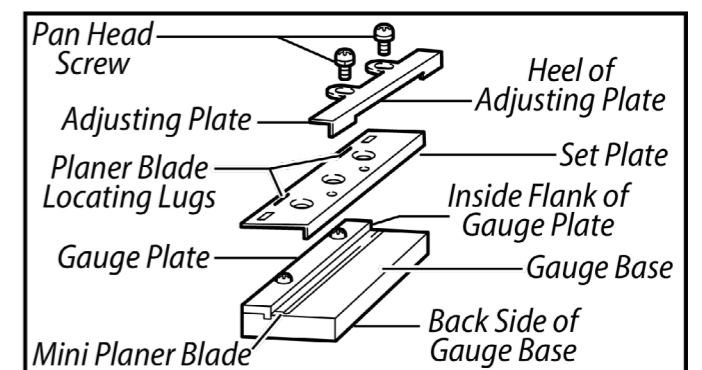

of the blade is perfectly flush with the inside flank of the gauge plate.

- Set the adjusting plate/set plate on the gauge base so that the planer blade locating lugs on the set plate rest in the mini planer blade groove, then press in the heel of the adjusting plate flush with the back side of the gauge base and tighten the pan head screws.
- It is important that the blade sits flush with the inside flank of the gauge plate, the planer blade locating lugs sit in the blade groove and the heel of the adjusting plate is flush with the back side of the gauge base. Check this alignment carefully to ensure uniform cutting.
- Slip the heel of the adjusting plate into the groove of the drum.

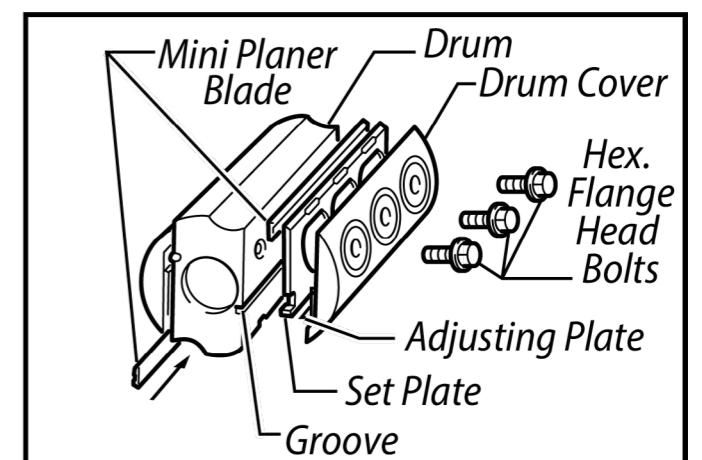

## ASSEMBLY

6. Set the drum cover over the adjusting plate/set plate and screw in the three hex flange head bolts so that a gap remains between the drum and the set plate to slide the mini planer blade into position. The blade will be positioned by the planer blade locating lugs on the set plate.
7. The blade's lengthwise adjustment will need to be manually positioned so that the blade ends are clear and equidistant from the housing on one side and the metal bracket on the other.
8. Tighten the three hex flange head bolts (with the socket wrench provided) and hand rotate the drum to check clearances between the blade ends and the tool body.
9. Check the three hex flange head bolts for final tightness.
10. Repeat procedures 1–9 for the other blade.

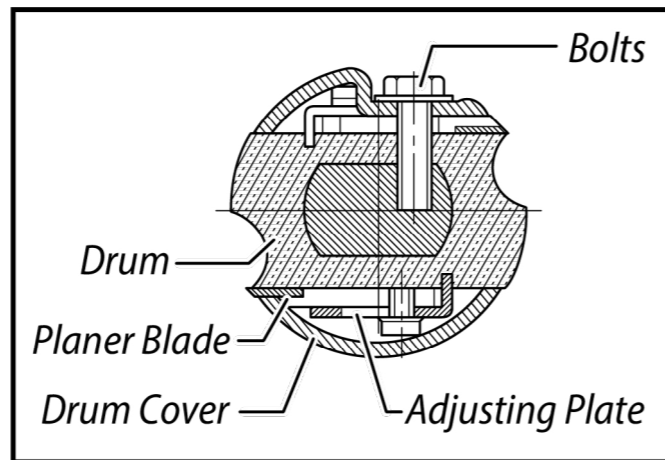

- Place the blade on the gauge base so that the blade edge is perfectly flush with the inside edge of the gauge plate.
- Place the adjusting plate on the blade, then simply press in the heel of the adjusting plate flush with the back side of the gauge base and tighten two screws on the adjusting plate.
- Now slip the heel of the adjusting plate into the drum groove, then fit the drum cover on it. Tighten all the installation bolts evenly and alternately with the socket wrench.
- Repeat the above procedures for the other blade.

### Installing Conventional Planer Blades

- To install the blades, first clean out all chips or foreign matter adhering to the drum or blades. Use blades of the same dimensions and weight, or drum oscillation/vibration will result, causing poor planing action and, eventually, tool breakdown.

## ASSEMBLY

### For the Correct Planer Blade Setting

- Your planing surface will end up rough and uneven, unless the blade is set properly and securely. The blade must be mounted so that the cutting edge is absolutely level, that is, parallel to the surface of the rear base. Below are some examples of proper and improper settings.

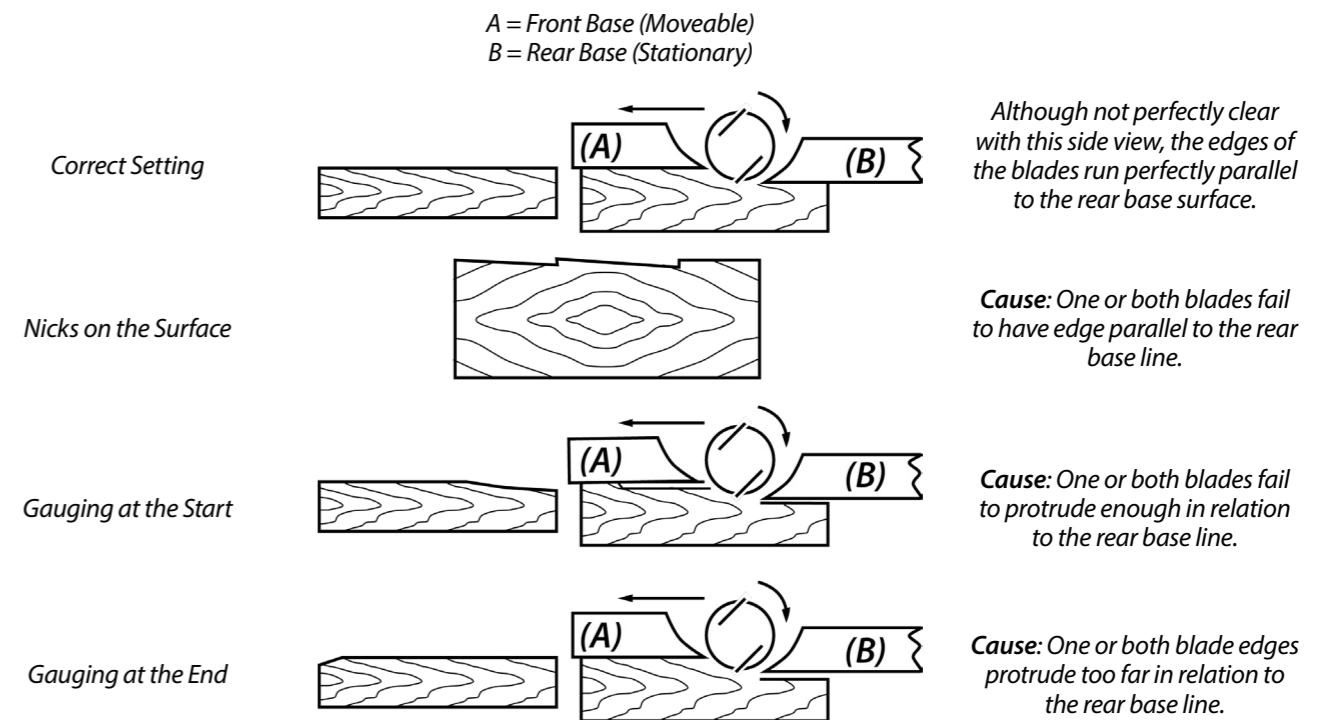

### Installing the Dust Bag

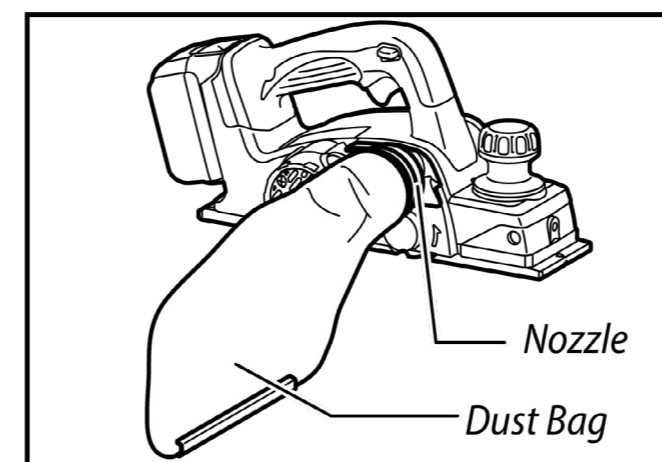

#### For the tool without the nozzle

- Remove the chip cover and install the nozzle (optional accessory). Attach the dust bag onto the nozzle. The nozzle is tapered.
- When attaching the dust bag, push it onto the nozzle firmly as far as it will go to prevent it from coming off during operation.

#### For the tool with the nozzle

- Attach the dust bag onto the nozzle. The nozzle is tapered.
- When attaching the dust bag, push it onto the nozzle firmly as far as it will go to prevent it from coming off during operation.

## ASSEMBLY

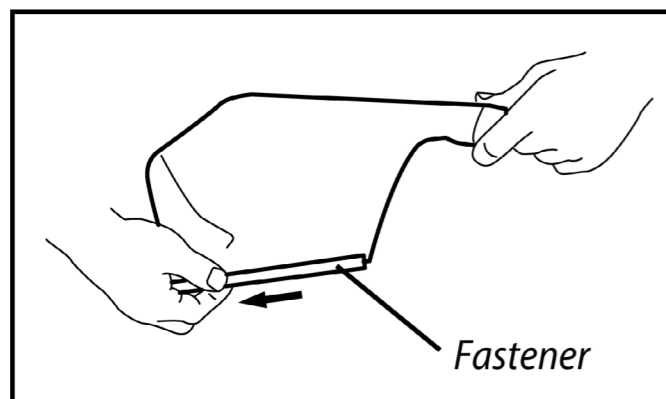

- When the dust bag is about half full, remove the dust bag from the tool and pull the fastener out. Empty the dust bag of its contents, tapping it lightly so as to remove particles adhering to the insides which might hamper further collection.

**NOTE: If you connect a ToolShed vacuum cleaner to this tool, more efficient and cleaner operations can be performed.**

### Connecting A Vacuum Cleaner

#### For the tool without the nozzle:

- When you wish to perform clean planing operations, connect a ToolShed vacuum cleaner to your tool.
- Before connecting the vacuum cleaner, remove the chip cover from the tool. Then connect the hose of the vacuum cleaner to the nozzle (optional accessory) as shown in the figure.

#### For the tool with the nozzle:

- When you wish to perform clean planing operation, connect a ToolShed vacuum cleaner to your tool. Then connect a hose of the vacuum cleaner to the nozzle as shown in the figure.

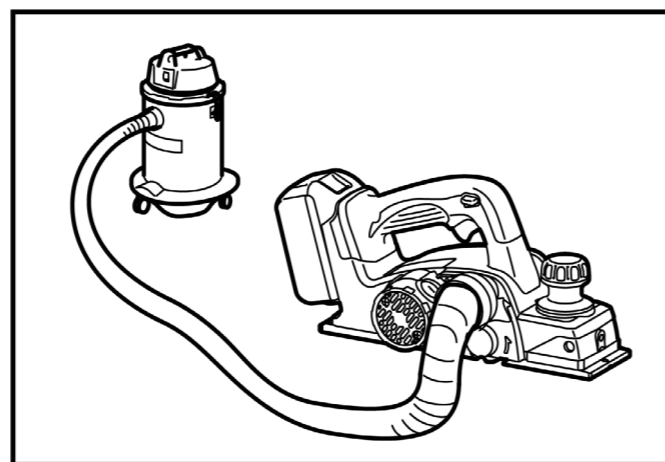

### Elbow (Optional Accessory)

- Use of the elbow allows a change of chip discharge direction to perform cleaner work.

#### For the tool without the nozzle:

- Remove the chip cover and install the nozzle (optional accessory). Attach the elbow (optional accessory) on the nozzle of the tool by just slipping it on. To remove it, just pull it out.

#### For the tool with the nozzle:

- Attach the elbow (optional accessory) on the nozzle of the tool by just slipping it on. To remove it, just pull it out.

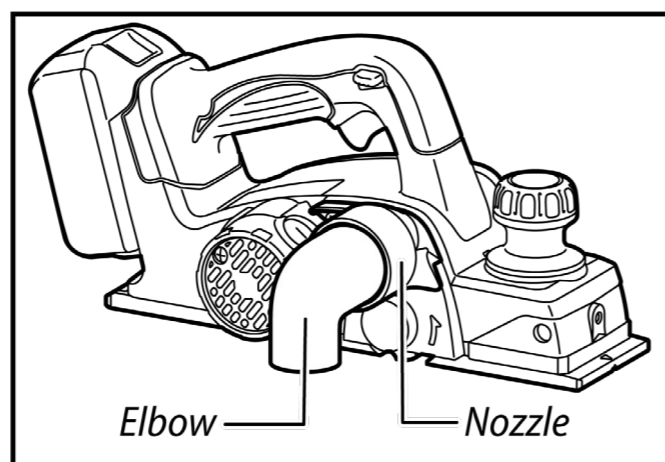

## OPERATION



### WARNING

*Hold the tool firmly with one hand on the knob and the other hand on the switch handle when operating the tool.*

### Planing Operation

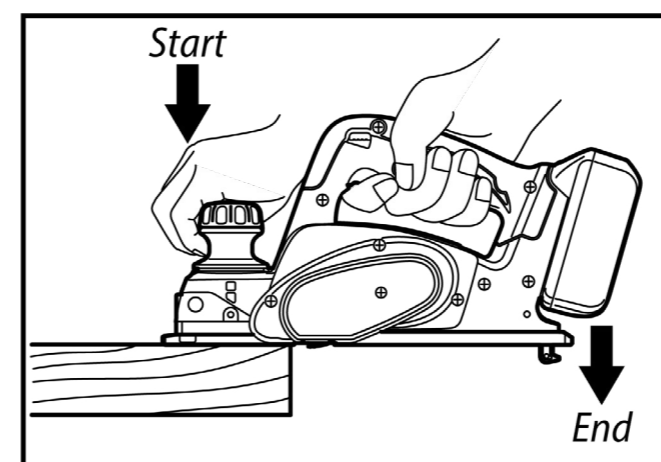

- First, rest the tool front base flat upon the workpiece surface without the blades making any contact. Switch the tool on and wait until the blades attain full speed. Then move the tool gently forward. Apply pressure on the front of tool at the start of planing, and at the back at the end of planing. Planing will be easier if you incline the workpiece in a stationary fashion, so that you can plane somewhat downhill.
- The speed and depth of cut determine the kind of finish. The power planer keeps cutting at a speed that will not result in jamming from chips. For rough cutting, the depth of cut can be increased, while for a good finish you should reduce the depth of cut and advance the tool more slowly.

### Rabbeting

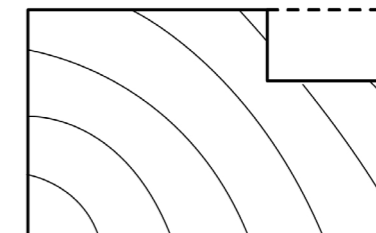

- To make a stepped cut as shown in the figure above, use the edge fence (guide rule) which is an optional accessory.

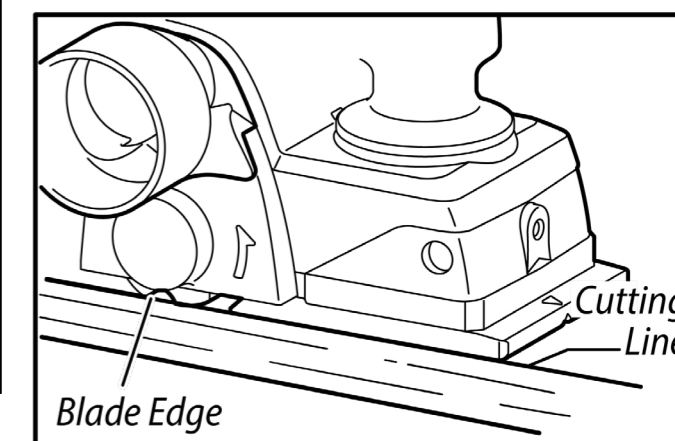

- Draw a cutting line on the workpiece. Insert the edge fence into the hole in the front of the tool. Align the blade edge with the cutting line.

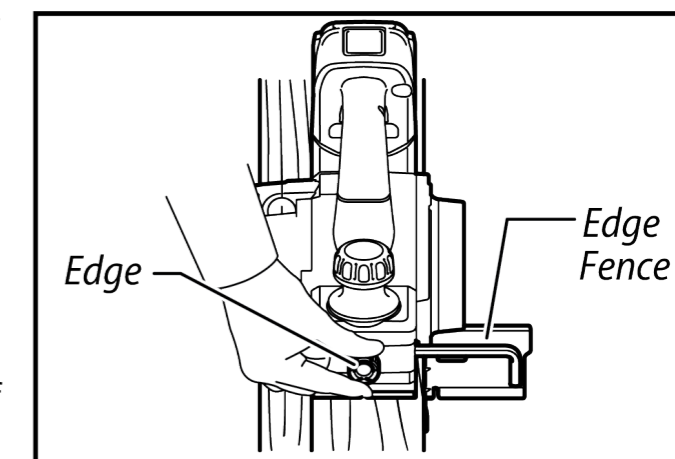

## OPERATION

- Adjust the edge fence until it comes in contact with the side of the workpiece, then secure it by tightening the screw.

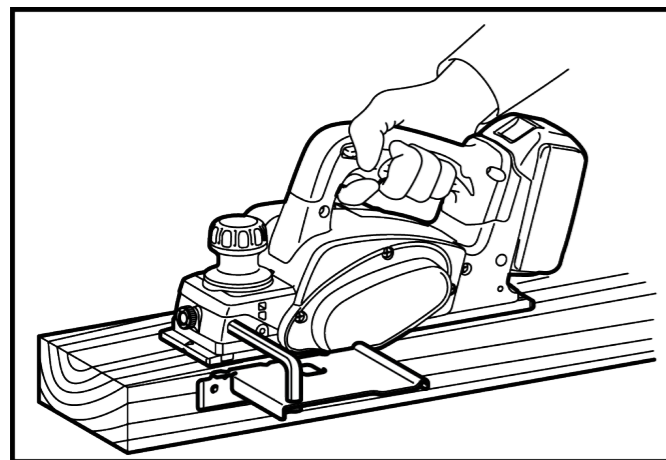

- When planing, move the tool with the edge fence flush with the side of the workpiece. Otherwise uneven planing may result.
- Maximum rabbeting depth is 9mm (11/32").

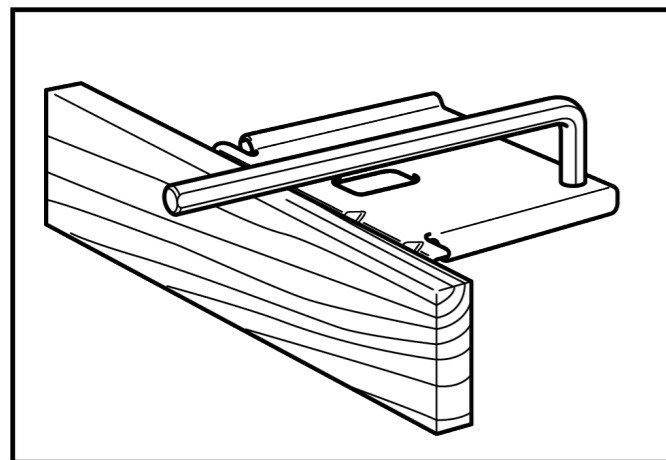

- You may wish to add to the length of the fence by attaching an extra piece of wood. Convenient holes are provided in the fence for this purpose, and also for attaching an extension guide (optional accessory).

### Chamfering

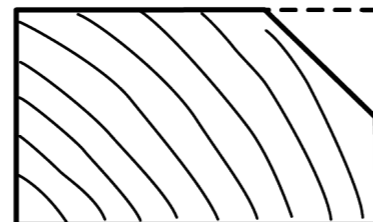

- To make a chamfering cut as shown in the figure above, align the "V" groove in the front base with the edge of the workpiece and plane it as shown below.

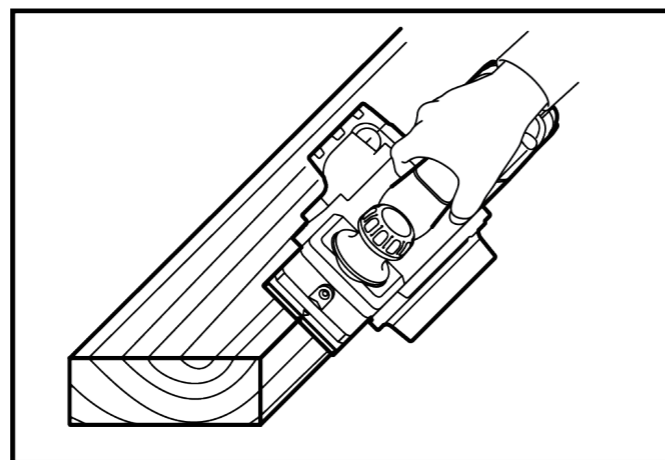

## MAINTENANCE

- Before cleaning or performing any maintenance, you must ensure the tool is switched off and disconnected from the power supply.
- Compressed air is the most effective way to clean this tool. Always wear PPE safety goggles when cleaning tools with compressed air.
- Check the carbon brushes of the machine in the event of excessive sparking.
- Ventilation openings and switch levers must be kept clean. DO NOT attempt to clean by inserting pointed objects through openings.
- Do not use harsh chemicals or solvents when cleaning this tool.
- If you discover any damaged or broken parts, consult your local XHD distributor for replacements and advise.



### WARNING

*Always be sure that the tool is switched off and the battery removed before attempting to perform any inspection or maintenance.*

### Environment & Disposal

- Packaging materials are raw materials and can be re-used. Separate the different packaging materials and take them to the appropriate waste disposal facility. More information can be obtained from your local authorities.
- Old machines do not belong in your household garbage! Dispose of old machines appropriately, we are all responsible for the environment.